

## Membrane screw connection - MG-INC-M20-S67L-PTES-LG - 1415187

Please be informed that the data shown in this PDF Document is generated from our Online Catalog. Please find the complete data in the user's documentation. Our General Terms of Use for Downloads are valid (<http://phoenixcontact.com/download>)



Membrane screw connection, Cable gland material: Polypropylene, Application: Standard, External cable diameter 6 mm ... 13 mm, Shielding: No, Connecting thread: M20, Color: lightgrey RAL 7035

The figure shows version MG-INC-M25-M67L-PTES-LG



### Key Commercial Data

|                        |          |
|------------------------|----------|
| Packing unit           | 1 STK    |
| Minimum order quantity | 20 STK   |
| Custom tariff number   | 39269097 |
| Country of origin      | Germany  |

### Technical data

#### Dimensions

|                                  |                |
|----------------------------------|----------------|
| Length                           | 15 mm          |
| Length without connecting thread | 7 mm           |
| Connecting thread diameter       | 20 mm          |
| Hexagon angular dimension GRP    | 34 mm          |
| Length of the connecting thread  | 8 mm           |
| External cable diameter          | 6 mm ... 13 mm |

#### Ambient conditions

|                                 |                  |
|---------------------------------|------------------|
| Degree of protection            | IP66             |
|                                 | IP67             |
| Ambient temperature (operation) | -40 °C ... 65 °C |

#### General

# Membrane screw connection - MG-INC-M20-S67L-PTES-LG - 1415187

## Technical data

### General

|                                |   |
|--------------------------------|---|
| Cable gland material           | Polypropylene   |
| Seal material                  | TPE   |
| Shielded                       | No  |
| Thread type on connection side | M20   |
| Color                          | light grey RAL 7035   |
|                                | lightgrey RAL 7035  |
| Assembly instructions          | for 0.8 mm ... 3.5 mm wall thickness, for 20 mm ... 20.7 mm bore hole |

## Drawings

Dimensional drawing

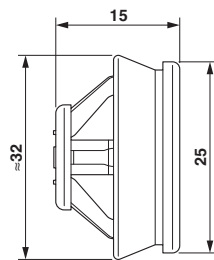

## Classifications

### eCl@ss

|            |          |
|------------|----------|
| eCl@ss 5.1 | 27149109 |
| eCl@ss 6.0 | 27149109 |
| eCl@ss 8.0 | 27379216 |
| eCl@ss 9.0 | 27379216 |

### ETIM

|          |          |
|----------|----------|
| ETIM 5.0 | EC002024 |
|----------|----------|